

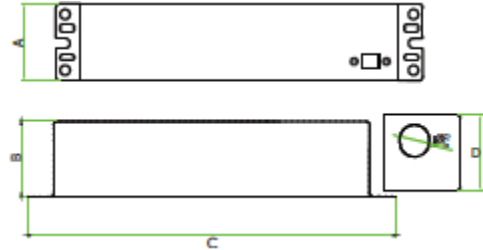

DIMENSIONS:

2.18"(A) x 2.16"(B) x 10.41"(C) x 2.18"(D) x Ø0.87"(E)



ELB-1248-EXTR

LED Emergency Ballast

This LED Emergency Ballast meets UL requirements to be used in both normal and emergency operation. In the event of a power failure, the LED Emergency Ballast will switch to "Emergency Mode" and operate the existing fixture for at least 90 minutes. The unit contains a battery, charger and converter circuit in a single can.

TECHNICAL SPECIFICATIONS:

- Input voltage: 120-277VAC, 50/60Hz
- Input current: 65mA Max
- Input power: 4.8W Max
- Output voltage: 12V-48VDC
- Max connected load: 0.75A
- Output power: 12W Max
- Recharge: 24 hours
- Emergency operation: ≥ 90 minutes
- Battery: High temp Ni-Cad (7-10 year life expectancy)

COMPATABILITY WITH WESTGATE FIX-

The internal DC voltages of all Westgate LED Commercial Lighting products are within the DC voltage range of this ballast, 12-48VDC.

With a maximum output of 12W AC, this ballast can operate any Westgate fixture with a wattage of 60W or less for at least 90 minutes.

CERTIFICATIONS: UL



MODEL	EMERGENCY POWER	SWITCH SELECT	VOLTAGE	CURRENT
ELB-1248-EXTR	12W	1	12V~16V	0.75A
		2	16V~24V	0.5A
		3	24V~36V	0.33A
		4	36V~48V	0.25A

FEATURES:

- Includes test switch and charge indicator accessory kit
- For use with switches or unswitched fixtures
- Dial the code to suitable rated voltage of luminaire
- Long life, high-temperature recyclable Ni-Cad battery.
- Meets or exceeds all National Electrical Code and Life Safety Code Emergency Lighting standards.

UL REQUIREMENTS:

UL requirements demand that, in emergency mode, a fixture must be illuminated at minimum 20% of its wattage for at least 90 minutes.

WARRANTY: 5 years



ELB-1248-EXTR

LED Emergency Ballast

MODEL	EMERGENCY POWER	SWITCH SELECT	VOLTAGE	CURRENT
ELB-1248-EXTR	12W	1	12V~16V	0.75A
		2	16V~24V	0.5A
		3	24V~36V	0.33A
		4	36V~48V	0.25A

TYPICAL WIRING DIAGRAM:

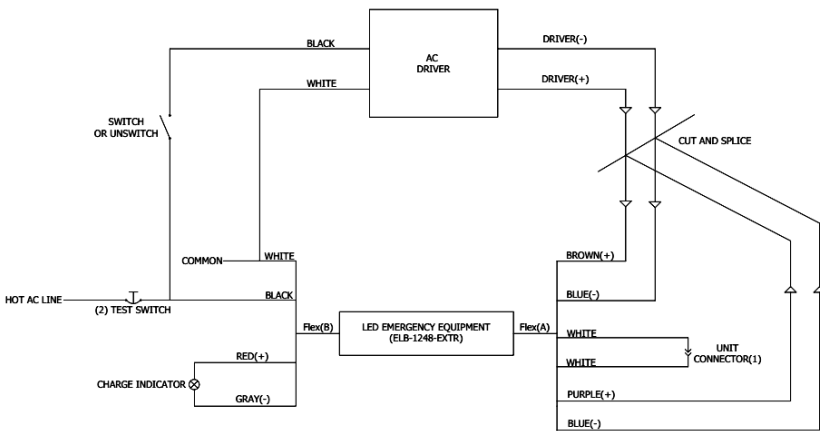

NOTE:

- (1) **UNIT CONNECTOR(WHITE WIRES):** DO NOT MATE CONNECTOR UNTIL INSTALLATION IS COMPLETE AND AC POWER IS SUPPLIED.
- (2) **TEST ACCESSORY LEADS-**OBSERVE PROPER POLARITY WIRING.

